

## Cup-shaped vacuum cups

Diameter 15 mm, with or without support, rubber

### MATERIAL

Vacuum cup in oil-proof rubber (NBR), natural (NR), or silicone (VMQ).

Nickel-plated brass support.

### STANDARD EXECUTIONS

- **VVH-15-A**: oil-proof rubber, without support.
- **VVH-15-N**: natural rubber, without support.
- **VVH-15-S**: silicone rubber, without support.
- **VVH-15-T-A**: oil-proof rubber, with support.
- **VVH-15-T-N**: natural rubber, with support.
- **VVH-15-T-S**: silicone rubber, with support.

### FEATURES AND APPLICATIONS

They can also be used in various sectors including electronics for gripping of electrical components, food packaging, and for handling products with very different technical characteristics in terms of size, materials (metal or plastic), form, and gripping surfaces (flat, slightly convex or concave).

See Technical Data for vacuum cups (on page -).

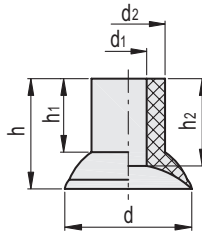

### VVH-15-A

Code	Description	d	d1	d2	h	h1	h2	F* [Kg]	Volume # [mm3]	⚖
VV.52044	VVH-15-A	15	4	8	12	8	9.5	0.5	364	1

### VVH-15-N

Code	Description	d	d1	d2	h	h1	h2	F* [Kg]	Volume # [mm3]	⚖
VV.52045	VVH-15-N	15	4	8	12	8	9.5	0.5	364	1

### VVH-15-S

Code	Description	d	d1	d2	h	h1	h2	F* [Kg]	Volume # [mm3]	⚖
VV.52046	VVH-15-S	15	4	8	12	8	9.5	0.5	364	1

\* The force of the vacuum cups indicated in the table represents 1/3 of the value of the theoretical force calculated at a vacuum level of -75 KPa and a safety coefficient of 3.

# Indicates the internal geometric volume of the vacuum cup and represents the volume to be added to the entire distribution circuit for the calculation of the evacuation time, especially if multiple vacuum cups are used.



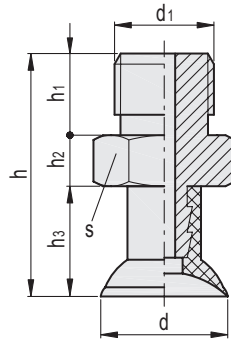

VVH-15-T-A

Code	Description	d	d1	h	h1	h2	h3	s	F* [Kg]	Volume # [mm3]	⚖️
VV.52047	VVH-15-G1/8-T-A	15	G1/8	25	8	5	12	12	0.5	364	10

VVH-15-T-N

Code	Description	d	d1	h	h1	h2	h3	s	F* [Kg]	Volume # [mm3]	⚖️
VV.52048	VVH-15-G1/8-T-N	15	G1/8	25	8	5	12	12	0.5	364	10

VVH-15-T-S

Code	Description	d	d1	h	h1	h2	h3	s	F* [Kg]	Volume # [mm3]	⚖️
VV.52049	VVH-15-G1/8-T-S	15	G1/8	25	8	5	12	12	0.5	364	10

\* The force of the vacuum cups indicated in the table represents 1/3 of the value of the theoretical force calculated at a vacuum level of -75 KPa and a safety coefficient of 3.

# Indicates the internal geometric volume of the vacuum cup and represents the volume to be added to the entire distribution circuit for the calculation of the evacuation time, especially if multiple vacuum cups are used.